

All you need for professional repairs

Timing belt kit with water pump and camshaft gear

febi no. 36444

Repl. no. 77 01 477 023 S2

Fits Renault 1.6 16V (K4M) engines

In the engines referred to above, the camshaft gear or the dephaser pulley responsible for adjustment of the variable timing sits on the intake camshaft. The camshaft gear has a frequent tendency towards early failure which becomes noticeable due to a loud knocking noise.



Attention!

febi bilstein recommends replacing the camshaft gear at the same time as changing the timing belt. Failure of the dephaser pulley can otherwise lead to engine management problems.

febi bilstein is currently the only supplier in the automotive aftermarket to offer a complete kit (febi no. 36444) which, in addition to the timing belt kit (febi no. 36300), also includes the camshaft gear (febi no. 36415) and the water pump (febi no. 21239). This combination enables a professional repair and avoids potential complaints. That saves time and money for both workshop and customer!

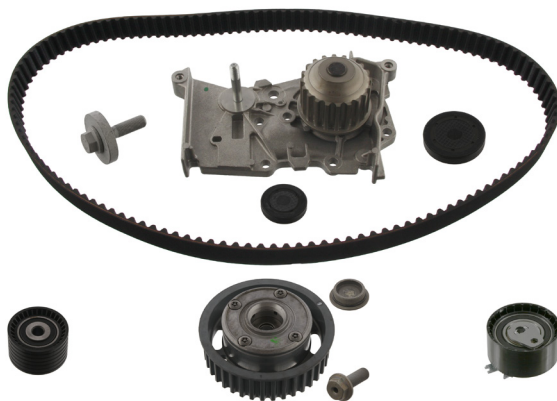

febi no. 36444

febi bilstein also supplies all the components in the set separately.

Simply ask for spare parts by febi bilstein.
The complete range can be found at: www.febi.com

febi no. 36415

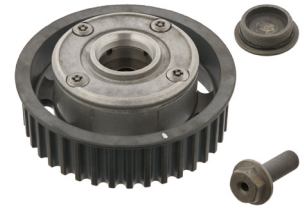

febi no. 36300



febi no. 21239

