

ELECTRONICAL THROTTLE BODY

CONTROL UNIT DOES NOT DETECT THE THROTTLE BODY

A11205

1. SELF LEARNING:

If the throttle body is installed in the vehicle, do not start the engine immediately!

The first operation should be:

1. Turn on the key, wait 1 minute! The throttle body gets electricity and has the chance of self-learning by the electronic control unit (ECU).
2. Turn off the key, power off!
3. Turn on the key again and finally start the engine.

If the ECU still does not accept the throttle body:

1. Shut down the power of the ECU and wait 1 minute. Turn on the power again!
2. Repeat these operations of self-learning which are mentioned above. (1, 2 & 3).

2. CHECK THE FEMALE PLUG

If the throttle body does not work after you started the engine, please check the female plug carefully. Try to connect the female plug with the part again and make sure that both sides match well!

3. CHECK THE GASKET

If the gasket of the throttle body doesn't match well with the surface of the item, it will cause leakage. Feedback signal will be ERROR.

If the throttle body still not work after these operations, please contact your supplier.

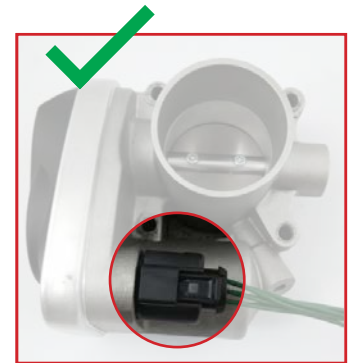
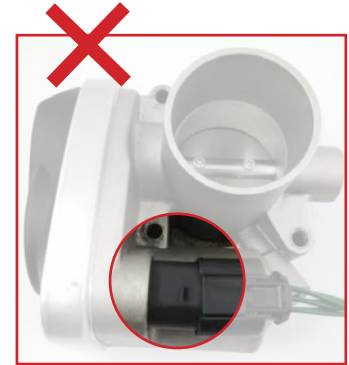

The female plug must snap firmly at the throttle body.



IMPORTANT!

Return consignments will not be accepted where adaption of the throttle body cannot be proven!

Notes: Temporary offers are only valid while stocks last. All offers remain subject to prior sale. Our general terms and conditions of sale and delivery as well as our warranty conditions apply, which are available for download on our website. All prices are net prices. Errors excepted. Reference numbers of vehicle manufacturers are non-binding and no indication of origin. They may not be disclosed in invoices. © VIEROL AG

한국 일본 자동차 부품